

AM46 Type Metric Wipers

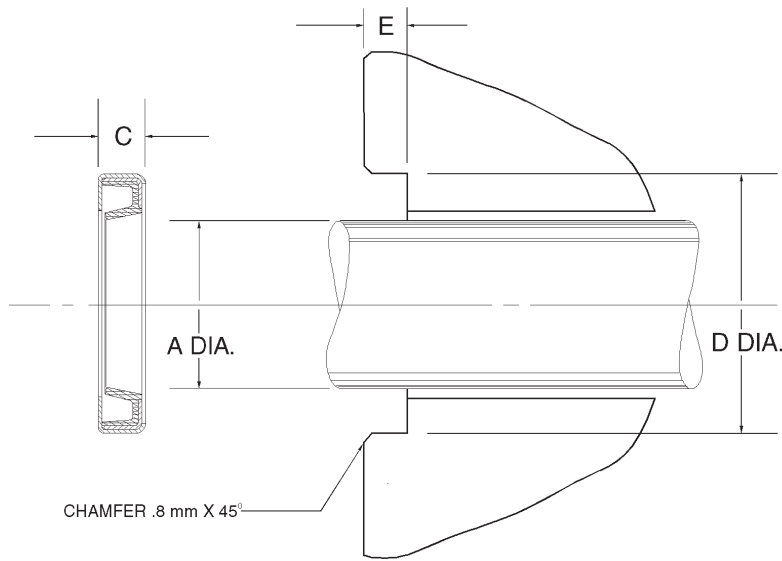

AM46 series wipers are similar to the AM45 series but have a double metal can making them more rigid. They are also used mainly for hinge pin applications.

Temperature: -40 to 230F

AM46 Pin Wipers

Part Number							Price
Prefix	Rod Dia. A mm	Groove Dimensions			Price		
		Bore D mm H8	X	Groove Height E mm			
AM46	- 35	X 45	X 4	\$ 11.79			
AM46	- 40	X 50	X 4	\$ 11.79			
AM46	- 40	X 50	X 6	\$ 11.79			
AM46	- 45	X 55	X 4	\$ 12.30			
AM46	- 50	X 60	X 4	\$ 13.84			
AM46	- 50	X 60	X 5	\$ 14.15			
AM46	- 50	X 60	X 6	\$ 14.66			
AM46	- 50	X 65	X 6	\$ 16.20			
AM46	- 55	X 68	X 4	\$ 15.48			
AM46	- 55	X 70	X 6	\$ 17.68			
AM46	- 55	X 75	X 6	\$ 17.68			
AM46	- 60	X 75	X 4	\$ 17.68			
AM46	- 60	X 75	X 6	\$ 18.50			
AM46	- 65	X 80	X 4	\$ 19.37			
AM46	- 65	X 80	X 6	\$ 20.71			
AM46	- 65	X 80	X 8	\$ 22.55			
AM46	- 65	X 85	X 5	\$ 21.53			
AM46	- 65	X 85	X 6	\$ 22.55			
AM46	- 70	X 80	X 6	\$ 20.71			
AM46	- 70	X 85	X 4	\$ 10.23			
AM46	- 70	X 85	X 6	\$ 22.40			
AM46	- 70	X 90	X 9.5	\$ 25.27			
AM46	- 70	X 95	X 9.5	\$ 30.14			

Part Number							Price
Prefix	Rod Dia. A mm	Groove Dimensions			Price		
		Bore D mm H8	X	Groove Height E mm			
AM46	- 90	X 105	X 9.5	\$ 29.47			
AM46	- 90	X 110	X 9.5	\$ 37.21			
AM46	- 95	X 110	X 9.5	\$ 37.21			
AM46	- 95	X 115	X 9.5	\$ 39.57			
AM46	- 100	X 115	X 4	\$ 16.30			
AM46	- 100	X 115	X 8	\$ 36.85			
AM46	- 100	X 120	X 6	\$ 36.18			
AM46	- 100	X 120	X 8	\$ 38.75			
AM46	- 110	X 125	X 4	\$ 28.80			
AM46	- 100	X 120	X 9.5	\$ 42.08			
AM46	- 110	X 125	X 8	\$ 41.41			
AM46	- 110	X 125	X 9.5	\$ 44.64			
AM46	- 110	X 130	X 8	\$ 44.95			
AM46	- 110	X 130	X 9.5	\$ 47.30			
AM46	- 110	X 135	X 8	\$ 49.46			
AM46	- 110	X 140	X 8	\$ 50.53			
AM46	- 120	X 135	X 8	\$ 46.33			
AM46	- 120	X 135	X 9.5	\$ 50.02			
AM46	- 120	X 140	X 9.5	\$ 51.56			
AM46	- 130	X 155	X 9.5	\$ 61.45			
AM46	- 140	X 155	X 8	\$ 70.53			
AM46	- 160	X 180	X 9.5	\$ 94.81			
AM46	- 190	X 220	X 8	\$ 117.52			