

8600 Type Double Lip Nitrile Wipers

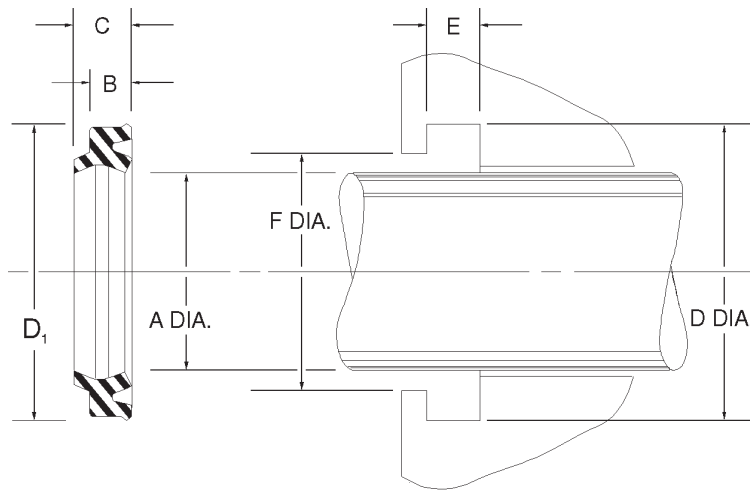

8600 type double lip wipers are one piece snap-in type rod wipers made from 90 durometer nitrile. Wiping and sealing functions can be performed from a single component in low pressure systems. As the outer lip scrapes foreign matter from the rod, the inner lip acts as an effective pressure seal in low pressure pneumatic applications and a secondary seal to trap slight leakage in hydraulic systems. We recommend the use of the 8600 type rubber wiper over the H type urethane wiper when using a rubber rod seal.

Temperature: -40 to 250F

8600 Wipers

Part No.	Wiper Dimensions (in.)				Groove Dimensions			Price
	Rod Dia. A	Out-side Dia. D ₁	B Base Height	C Total Height	D +0.02 -0.000	(E) +0.005 -0.000	F +0.002 -0.000	
8600-0037	0.375	11/16	0.194	.245	0.677	.203	0.495	\$ 4.67
8600-0050	0.500	13/16	0.194	.245	0.802	.203	0.620	\$ 4.67
8600-0062	0.625	15/16	0.194	.245	0.927	.203	0.745	\$ 4.76
8600-0068	0.688	1	0.194	.245	0.990	.203	0.808	\$ 10.46
8600-0075	0.750	1-1/16	0.194	.245	1.052	.203	0.870	\$ 5.08
8600-0087	0.875	1-1/4	0.212	.275	1.240	.218	1.010	\$ 5.16
8600-0100	1.000	1-3/8	0.212	.275	1.365	.218	1.135	\$ 5.69
8600-0112	1.125	1-1/2	0.212	.275	1.490	.218	1.260	\$ 5.77
8600-0125	1.250	1-5/8	0.212	.275	1.615	.218	1.385	\$ 5.87
8600-0137	1.375	1-3/4	0.212	.275	1.740	.218	1.510	\$ 6.18
8600-0150	1.500	1-7/8	0.212	.275	1.865	.218	1.635	\$ 6.26
8600-0162	1.625	2	0.212	.275	1.990	.218	1.760	\$ 6.34
8600-0175	1.750	2-1/8	0.212	.275	2.115	.218	1.885	\$ 6.44
8600-0187	1.875	2-1/4	0.212	.275	2.240	.218	2.010	\$ 6.47
8600-0200	2.000	2-3/8	0.212	.275	2.365	.218	2.135	\$ 6.88
8600-0212	2.125	2-1/2	0.212	.275	2.490	.218	2.260	\$ 14.83
8600-0218	2.188	2-11/16	0.212	.275	2.683	.218	2.323	\$ 14.98
8600-0225	2.250	2-3/4	0.275	.351	2.745	.281	2.385	\$ 15.41
8600-0250	2.500	3	0.275	.351	2.995	.281	2.635	\$ 7.35
8600-0268	2.688	3-3/16	0.275	.351	3.183	.281	2.823	\$ 16.04
8600-0275	2.750	3-1/4	0.275	.351	3.245	.281	2.885	\$ 16.65
8600-0293	2.937	3-7/16	0.275	.351	3.433	.281	3.073	\$ 17.91

Part No.	Wiper Dimensions (in.)				Groove Dimensions			Price
	Rod Dia.	Out-side	B Base Height	C Total Height	D +0.003	E +0.005	F +0.003	
8600-0300	3.000	3-1/2	0.275	.351	3.495	.281	3.135	\$ 13.19
8600-0325	3.250	3-3/4	0.275	.351	3.745	.281	3.385	\$ 18.50
8600-0343	3.437	3-15/16	0.275	.351	3.932	.281	3.572	\$ 18.52
8600-0350	3.500	4	0.275	.351	3.995	.281	3.635	\$ 13.80
8600-0368	3.688	4-3/16	0.275	.351	4.183	.281	3.823	\$ 18.82
8600-0375	3.750	4-1/4	0.275	.351	4.245	.281	3.885	\$ 19.13
8600-0400	4.000	4-1/2	0.275	.351	4.495	.281	4.135	\$ 19.15
8600-0425	4.250	4-3/4	0.275	.351	4.745	.281	4.385	\$ 19.72
8600-0443	4.438	4-15/16	0.275	.351	4.933	.281	4.573	\$ 20.74
8600-0450	4.500	5	0.275	.351	4.995	.281	4.635	\$ 21.31
8600-0475	4.750	5-1/4	0.275	.351	5.245	.281	4.885	\$ 21.99
8600-0500	5.000	5-1/2	0.275	.351	5.495	.281	5.135	\$ 22.89
8600-0518	5.188	5-11/16	0.275	.351	5.683	.281	5.323	\$ 24.63
8600-0550	5.500	6	0.275	.351	5.995	.281	5.635	\$ 25.11
8600-0600	6.000	6-1/2	0.275	.351	6.495	.281	6.135	\$ 26.68
8600-0675	6.750	7-1/4	0.275	.351	7.245	.281	6.885	\$ 27.21
8600-0700	7.000	7-1/2	0.275	.351	7.495	.281	7.135	\$ 28.01
8600-0725	7.250	7-3/4	0.275	.351	7.745	.281	7.385	\$ 28.68
8600-0775	7.750	8-1/4	0.275	.351	8.245	.281	7.885	\$ 28.68
8600-0800	8.000	8-1/2	0.275	.351	8.495	.281	8.135	\$ 28.68
8600-0900	9.000	9-1/2	0.275	.351	9.495	.281	9.135	\$ 36.65
8600-0975	9.750	10-1/4	0.275	.351	10.245	.281	9.885	\$ 41.54
8600-1000	10.000	10-1/2	0.275	.351	10.495	.281	10.135	\$ 47.15

If you don't see it... Ask