

# CT Type Urethane Piston Cups

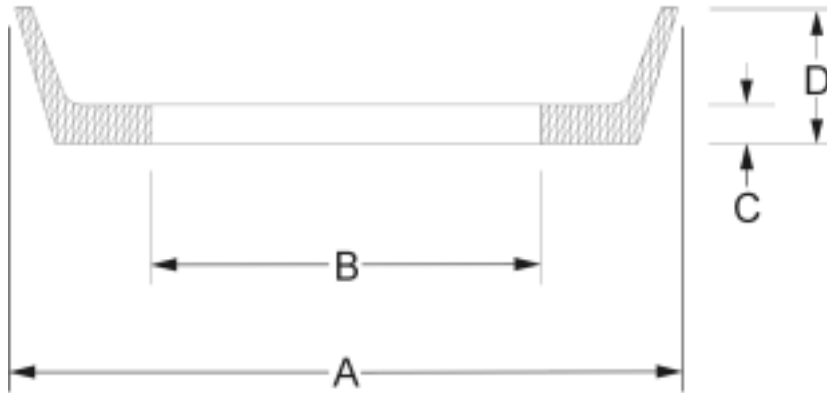

CT Series (Thin Wall) type piston cups are molded of urethane impregnated with molybdenum disulfide and are recommended for pneumatic applications. The thinner lip relative to base thickness results in lower friction and longer wear. Cups are supplied solid. Center holes ("B") are available at an additional charge.

Temperature: -65 to 200F

Pressure: 0 to 1,500 PSI

Part Number	Bore Dia. A	Base Height C	Total Height D	Price
CT0437-187	7/16	3/32	3/16	\$ 3.49
CT0437-250	7/16	1/16	1/4	\$ 3.49
CT0437-375	7/16	1/16	3/8	\$ 3.49
CT0500-375	1/2	3/32	3/8	\$ 3.49
CT0625-375	5/8	3/32	3/8	\$ 3.56
CT0750-375	3/4	3/32	3/8	\$ 3.63
CT0875-250-250	7/8	3/32	1/4	\$ 3.66
CT0875-375	7/8	3/32	3/8	\$ 3.66
CT1000-437	1	3/32	7/16	\$ 3.67
CT1125-437	1-1/8	3/32	7/16	\$ 4.23
CT1250-437	1-1/4	3/32	7/16	\$ 4.58
CT1375-437	1-3/8	3/32	7/16	\$ 4.85
CT1437-437	1-7/16	3/32	7/16	\$ 5.17
CT1500-437	1-1/2	3/32	7/16	\$ 5.45
CT1625-437	1-5/8	3/32	7/16	\$ 5.93
CT1750-437	1-3/4	3/32	7/16	\$ 6.36
CT1875-437	1-7/8	3/32	7/16	\$ 6.84
CT1937-437	1-15/16	3/32	7/16	\$ 7.10
CT2000-312	2	1/8	5/16	\$ 7.31
CT2000-437	2	1/8	7/16	\$ 7.31
CT2000-500	2	1/8	1/2	\$ 7.31
CT2125-500	2-1/8	1/8	1/2	\$ 7.74
CT2250-500	2-1/4	1/8	1/2	\$ 8.19
CT2375-500	2-3/8	1/8	1/2	\$ 8.69
CT2500-500	2-1/2	1/8	1/2	\$ 9.10
CT2625-500	2-5/8	1/8	1/2	\$ 9.38
CT2750-500	2-3/4	1/8	1/2	\$ 9.98
CT2875-500	2-7/8	1/8	1/2	\$ 10.68

Part Number	Bore Dia. A	Base Height C	Total Height D	Price
CT2875-625	2-7/8	1/8	5/8	\$ 11.30
CT3000-625	3	1/8	5/8	\$ 11.47
CT3250-625	3-1/4	1/8	5/8	\$ 11.77
CT3375-625	3-3/8	1/8	5/8	\$ 12.24
CT3500-625	3-1/2	1/8	5/8	\$ 12.63
CT3750-625	3-3/4	1/8	5/8	\$ 13.58
CT4000-437	4	1/8	7/16	\$ 14.94
CT4000-625	4	1/8	5/8	\$ 14.94
CT4250-625	4-1/4	1/8	5/8	\$ 15.37
CT4500-625	4-1/2	1/8	5/8	\$ 16.27
CT4750-750	4-3/4	1/8	3/4	\$ 17.15
CT5000-562	5	1/8	9/16	\$ 19.95
CT5000-750	5	1/8	3/4	\$ 19.95
CT5250-750	5-1/4	1/8	3/4	\$ 22.75
CT5500-750	5-1/2	1/8	3/4	\$ 25.59
CT5750-562	5-3/4	1/8	9/16	\$ 28.30
CT5750-750	5-3/4	1/8	3/4	\$ 28.30
CT6000-750	6	1/8	3/4	\$ 31.15
CT6500-750	6-1/2	1/8	3/4	\$ 36.14
CT7000-750	7	1/8	3/4	\$ 39.54
CT8000-1000	8	1/8	1	\$ 45.18
CT8750-1000	8-3/4	1/8	1	\$ 49.38
CT10000-1000	10	1/8	1	\$ 56.38
CT11000-1250	11	3/16	1-1/4	\$ 79.24
CT12000-1250	12	3/16	1-1/4	\$ 104.56
CT12500-1250	12-1/2	3/16	1-1/4	\$ 108.08
CT13000-1250	13	3/16	1-1/4	\$ 111.62

CT Urethane Piston Cups

*Order by credit card...Today!*

