

# Fabric Reinforced Nitrile U-Cups

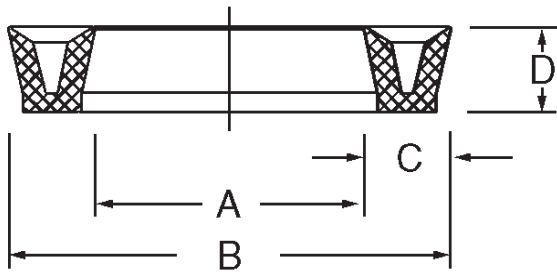

Rectangular Profile

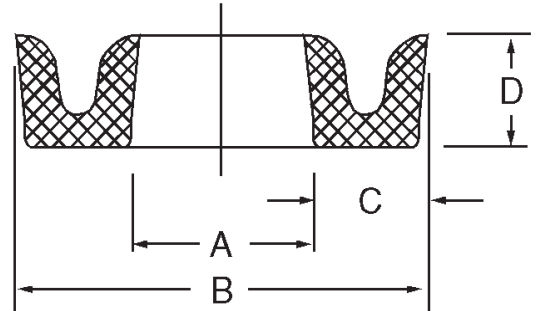

Contoured Profile (-1)

Cotton-Duck reinforced nitrile u-cups wear extremely well in heavy duty hydraulic cylinder applications. The wicking action of the cotton-duck material keeps the seal lubricated. The lip seal design also contributes to low friction.

Temperature: -20F to 200F

Pressure: 0 to 3500 psi

Part Number	Inside Dia. A	Outside Dia. B	Height D	Price
UCF15002000-375	1-1/2	2	3/8	\$ 5.94
UCF17502500-375-1	1-3/4	2-1/2	3/8	\$ 7.24
UCF17502500-500	1-3/4	2-1/2	1/2	\$ 8.43
UCF20002500-375	2	2-1/2	3/8	\$ 7.14
UCF20002750-500	2	2-3/4	1/2	\$ 8.52
UCF22502750-375	2-1/4	2-3/4	3/8	\$ 8.33
UCF22503000-375-1	2-1/4	3	3/8	\$ 9.28
UCF22503000-500	2-1/4	3	1/2	\$ 9.79
UCF25003000-375	2-1/2	3	3/8	\$ 7.58
UCF25003250-375-1	2-1/2	3-1/4	3/8	\$ 9.40
UCF25003250-500	2-1/2	3-1/4	1/2	\$ 10.28
UCF25003750	2-1/2	3-3/4	5/8	\$ 20.09
UCF27503250-375	2-3/4	3-1/4	3/8	\$ 10.06
UCF27503500-375-1	2-3/4	3-1/2	3/8	\$ 11.41
UCF27503500-500	2-3/4	3-1/2	1/2	\$ 11.69
UCF27503750-500	2-3/4	3-3/4	1/2	\$ 14.84
UCF30003500-375	3	3-1/2	3/8	\$ 7.78
UCF30003750-375-1	3	3-3/4	3/8	\$ 12.67
UCF30003750-500	3	3-3/4	1/2	\$ 12.67
UCF30004000-500	3	4	1/2	\$ 13.52
UCF32504000-375-1	3-1/4	4	3/8	\$ 9.81
UCF32504000-500	3-1/4	4	1/2	\$ 10.44
UCF35004000-375	3-1/2	4	3/8	\$ 11.17
UCF35004250-500	3-1/2	4-1/4	1/2	\$ 13.64
UCF37504500-375-1	3-3/4	4-1/2	3/8	\$ 13.05
UCF37504500-500	3-3/4	4-1/2	1/2	\$ 13.75
UCF37505000-750	3-3/4	5	3/4	\$ 21.23
UCF40004750-500	4	4-3/4	1/2	\$ 14.60
UCF40005000-500-1	4	5	1/2	\$ 15.22
UCF41255000-437-1	4-1/8	5	7/16	\$ 21.21
UCF42505000-500	4-1/4	5	1/2	\$ 17.39
UCF45005250-500	4-1/2	5-1/4	1/2	\$ 17.92

Part Number	Inside Dia. A	Outside Dia. B	Height D	Price
UCF47505500-500	4-3/4	5-1/2	1/2	\$ 18.52
UCF50006000-750-1	5	6	3/4	\$ 21.20
UCF52506000-500	5-1/4	6	1/2	\$ 20.22
UCF52506125-437-1	5-1/4	6-1/8	7/16	\$ 32.52
UCF55006250-500	5-1/2	6-1/4	1/2	\$ 21.05
UCF57506500-500	5-3/4	6-1/2	1/2	\$ 21.91
UCF60007000	6	7	1/2	\$ 34.96
UCF60007000-625-1	6	7	5/8	\$ 48.17
UCF62507000-500	6-1/4	7	1/2	\$ 26.67
UCF70008000-750	7	8	3/4	\$ 36.84
UCF72508000-500	7-1/4	8	1/2	\$ 29.83
UCF77508500-500	7-3/4	8-1/2	1/2	\$ 36.11
UCF80008750-500	8	8-3/4	1/2	\$ 36.54
UCF80009500	8	9-1/2	3/4	\$ 53.64
UCF82509000-500	8-1/4	9	1/2	\$ 38.59
UCF900011000	9	11	1	\$ 133.85
UCF925010000-500	9-1/4	10	1/2	\$ 40.88
UCF1000011000-625	10	11	5/8	\$ 53.57
UCF1125012000-500	11-1/4	12	1/2	\$ 47.14
UCF1150012500-1000	11-1/2	12-1/2	1	\$ 112.42
UCF1150013500-1187	11-1/2	13-1/2	1-3/16	\$ 156.73
UCF1162512625-1000	11-5/8	12-5/8	1	\$ 113.73
UCF1200013500-1000-1	12	13-1/2	1	\$ 136.75
UCF1200014000-1250	12	14	1-1/4	\$ 169.09
UCF1312513875-500	13-1/8	13-7/8	1/2	\$ 57.85
UCF1325014000-500	13-1/4	14	1/2	\$ 58.16
UCF1400015500-1000-1	14	15-1/2	1	\$ 151.15
UCF1525016000-500	15-1/4	16	1/2	\$ 65.62
UCF1687517875-750	16-7/8	17-7/8	3/4	\$ 124.95
UCF1700018000-750	17	18	3/4	\$ 133.19
UCF2000021750-1125	20	21-3/4	1-1/8	\$ 252.02
UCF2300024000-750-1	23	24	3/4	\$ 167.11